

# PET TESTING KIT

Babio Biotech owns overall and multiple pet health detection products, and can supply all kinds of pet disease detection services. There are two versions of the Babio pet test kits: cassette test kit and all-in-one test device.





# Cassette Test Kit

Safeguard pet health  
Care pet growth with pet owners

## Product Highlights

- 1** -High sensitivity, strong specificity  
Adopt the double-antibody sandwich immunochromatography method, achieve the sensitivity and specificity of the products by the specific binding reaction,with high accuracy.
- 2** -Advanced technology, GMP quality assurance  
Stick to the high-standard and demanding production process, own a 100,000-level purification production workshop.
- 3** -Convenient and safe storage  
Can be stored at 2-30°C; Sealed packaging, light and moisture proof, not affected by the external environment
- 4** -Fast detection, easy operation  
Home self-test products, fast and accurate detection, safe, economical and worry-free.

## 【Product Show】



Canine Coronavirus Antigen (CCV Ag) Test Kit



Canine Parvovirus Antigen (CPV Ag) Test Kit



Canine Distemper Virus Antigen (CDV Ag) Test Kit



Feline Coronavirus Antigen (FCoVAg) Test Kit



Feline Panleukopenia Virus Antigen (FPV Ag) Test Kit



Feline Herpes Virus Antigen (FHVAg) Test Kit



## 【Test Procedure】

1. Before use, restore the kit to room temperature (15-30°C).
2. Take out the test card from the aluminum foil bag, place it on a clean platform.
3. Unscrew the top cap of the diluent tube containing the sample, invert the diluent tube, squeeze the tube wall, add 3-5 drops of the sample mixture to the sample well (S hole) of the test card.
4. Read the results in 10-15 minutes. The result is invalid after 15 minutes.

## Operating procedure illustration

### 1. Sample collection steps of pet's nasal and ocular secretions:

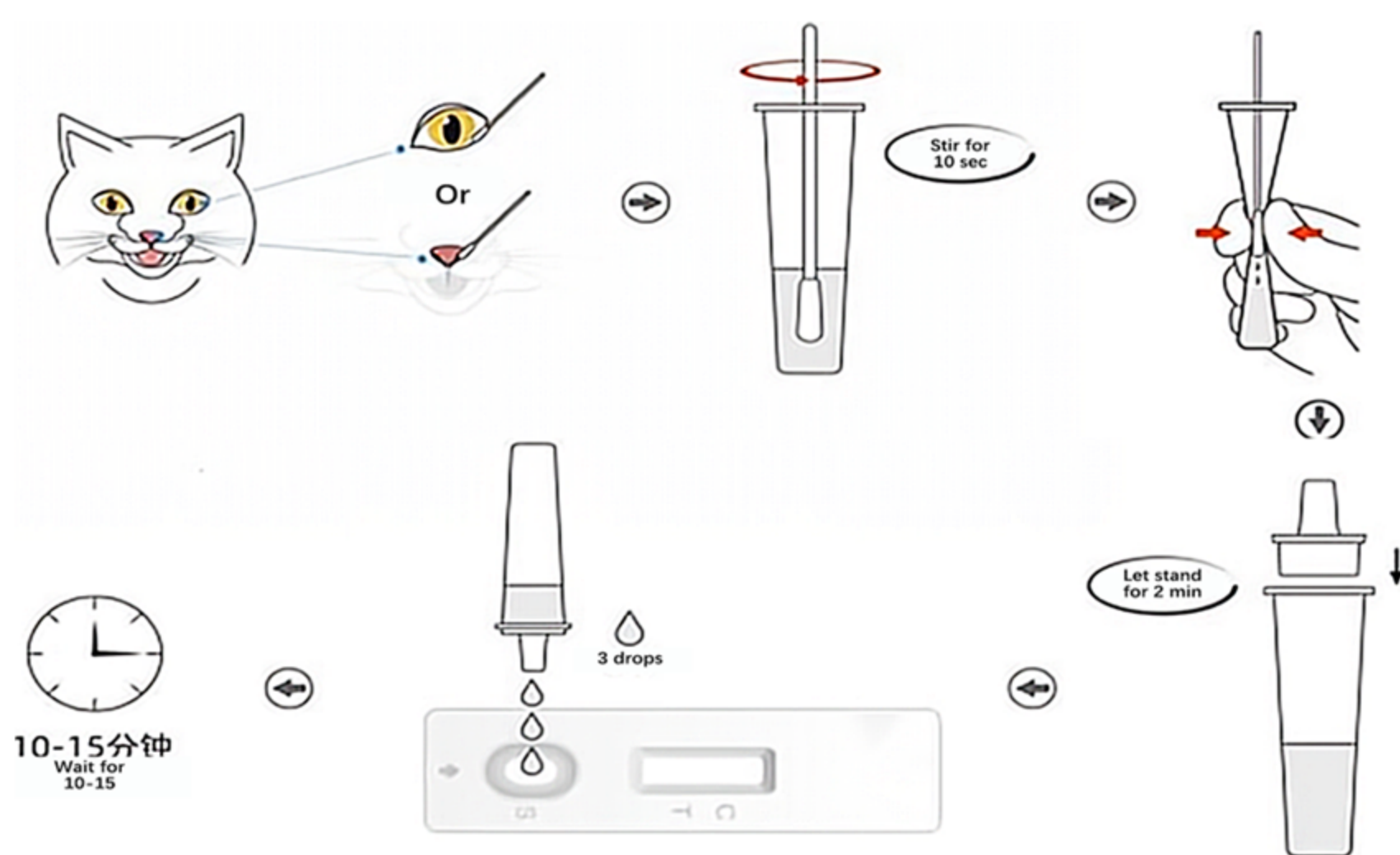

### 2. Sample collection steps of pet's faeces:

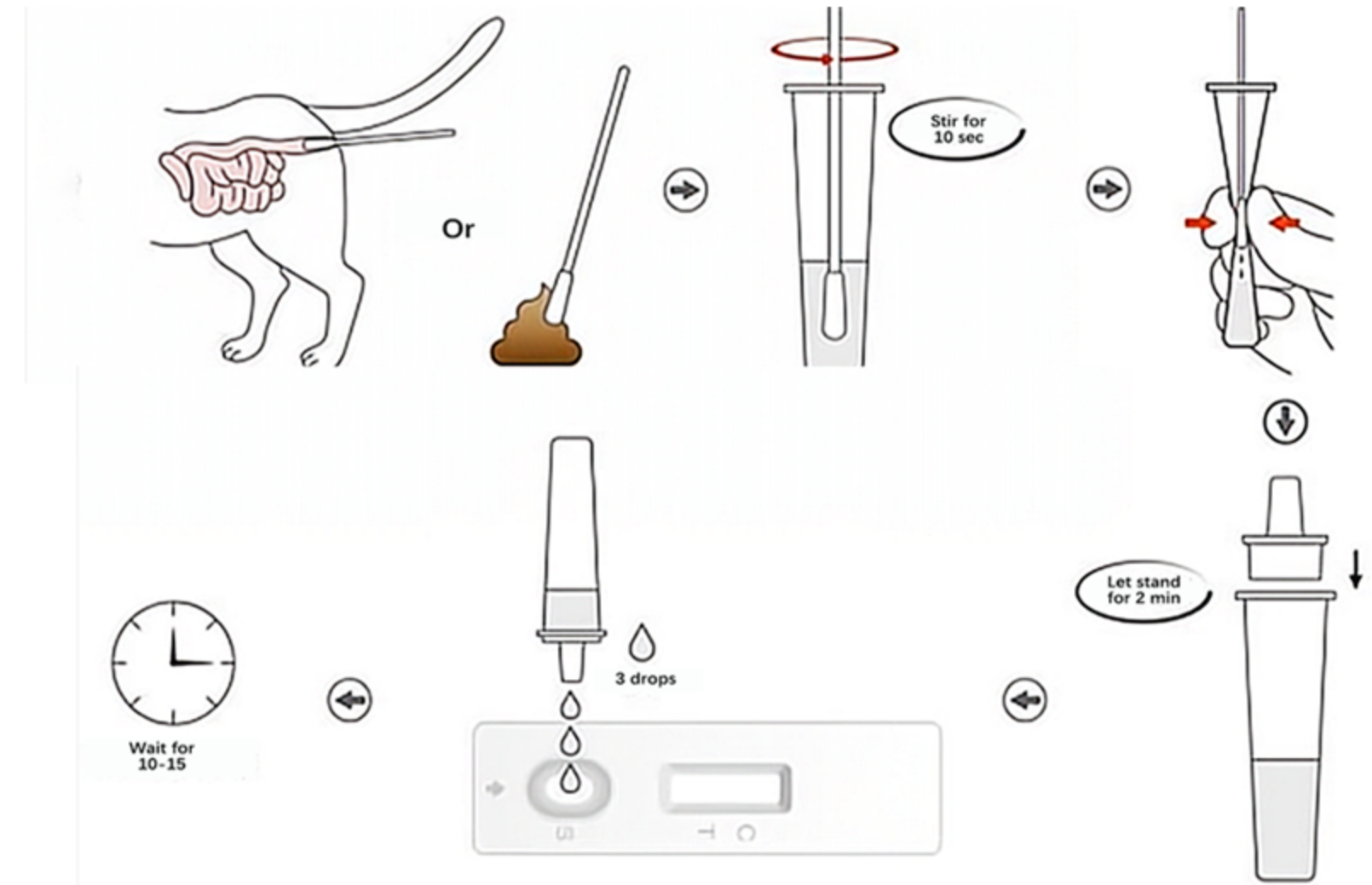

## 【Result Reading】

### Positive

Positive: Both the quality control line (C line)

### Negative

Only the quality control line

### Invalid

Quality control line does not appear. Shall take a new test card to retest.

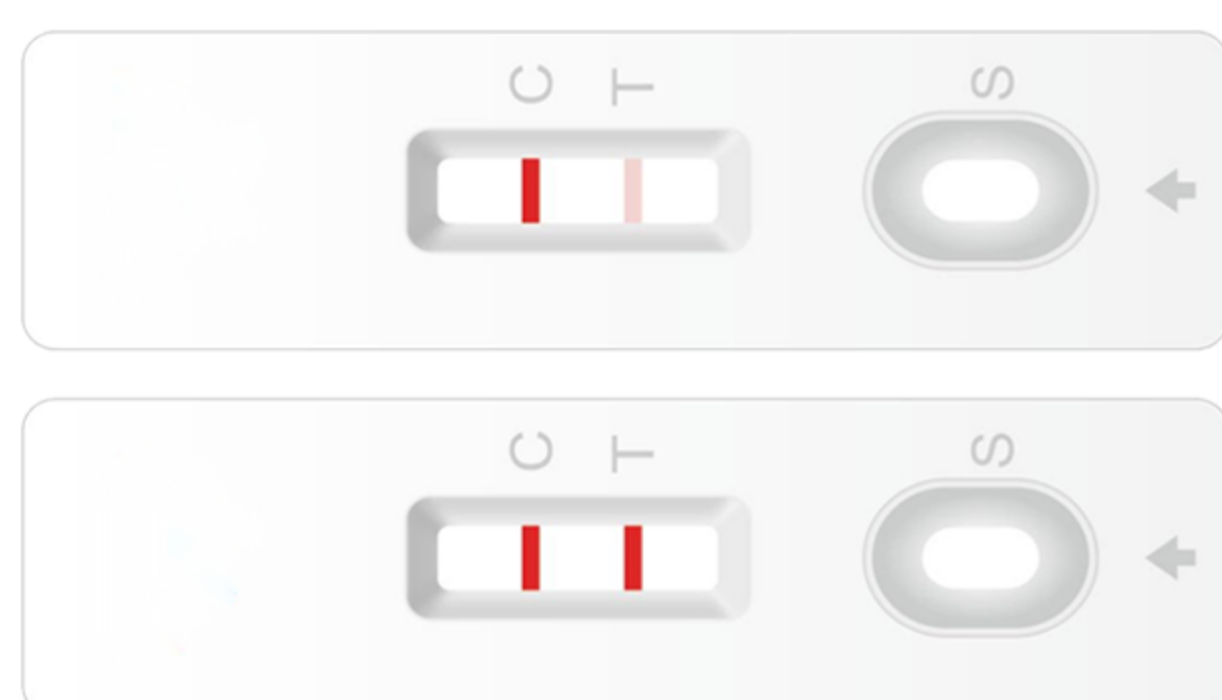

Positive



Negative



Invalid



# All-in-one test device

## A High-end Pet Health Detection Product

### Product Highlights

- 1** - American patent technology  
Adopt E.A.S.E. advanced core technology, have passed the rigorous scientific and clinical validation.
- 2** - Highly standardized production  
Own 10,000-level purification standard workshop, follow the GMP quality system to strictly control the production process.
- 3** - Integrated closed device  
Complete sample handling and testing in the same closed device, and the test results are with higher accuracy.
- 4** - Set the pet owners at ease  
Easy to operate, no cross contamination, and keep pet owners safe.

### 【Product Show】

All-in-one test device is an integrated closed system, belonging to the high-end pet test product. The treatment and detection of samples are proceeded under the same closed environment. It have the advantages of simple operation, cross-contamination free, environmental protection, etc.

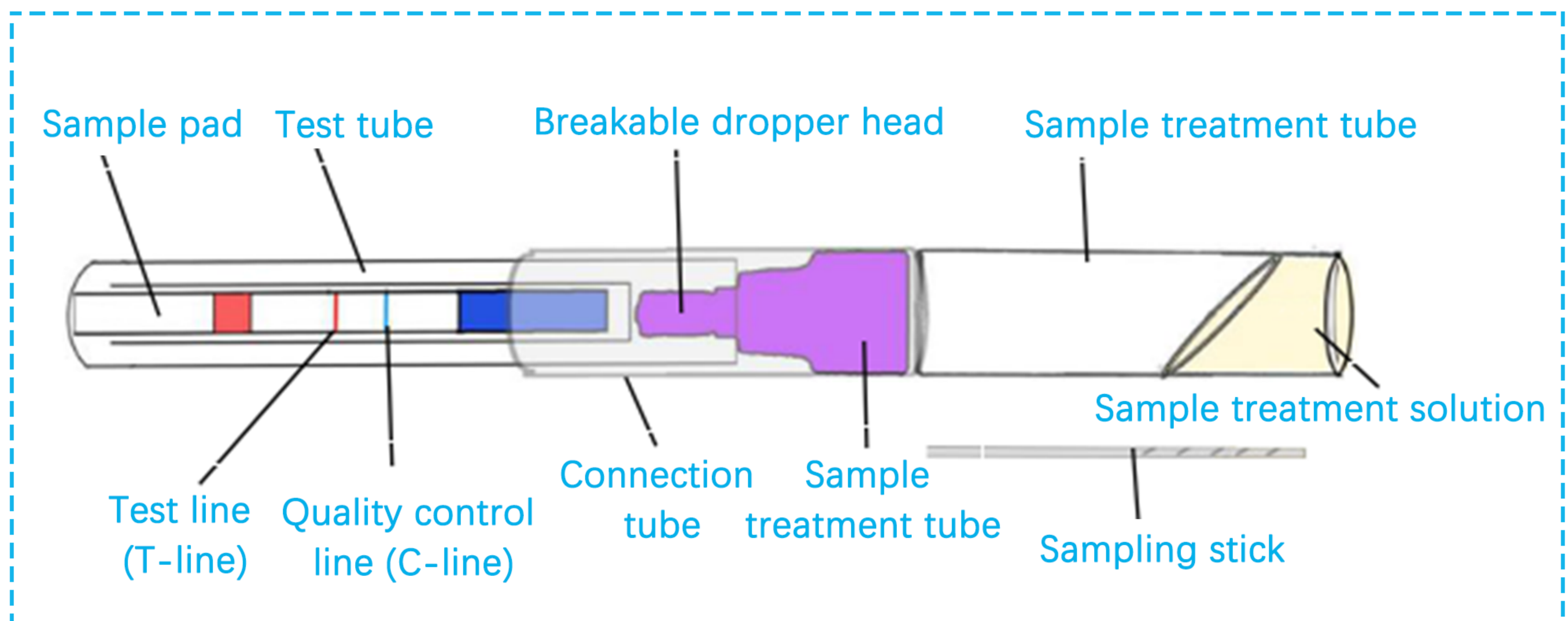



## 【Product Show】



## 【Test Procedure】

1. Before use, restore the kit to room temperature (15-30°C).
2. Take out the test card from the aluminum foil bag, place it on a clean platform.
3. Unscrew the top cap of the diluent tube containing the sample, invert the diluent tube, squeeze the tube wall, add 3-5 drops of the sample mixture to the sample well (S hole) of the test card.
4. Read the results in 10-15 minutes. The result is invalid after 15 minutes.

## Operating procedure illustration

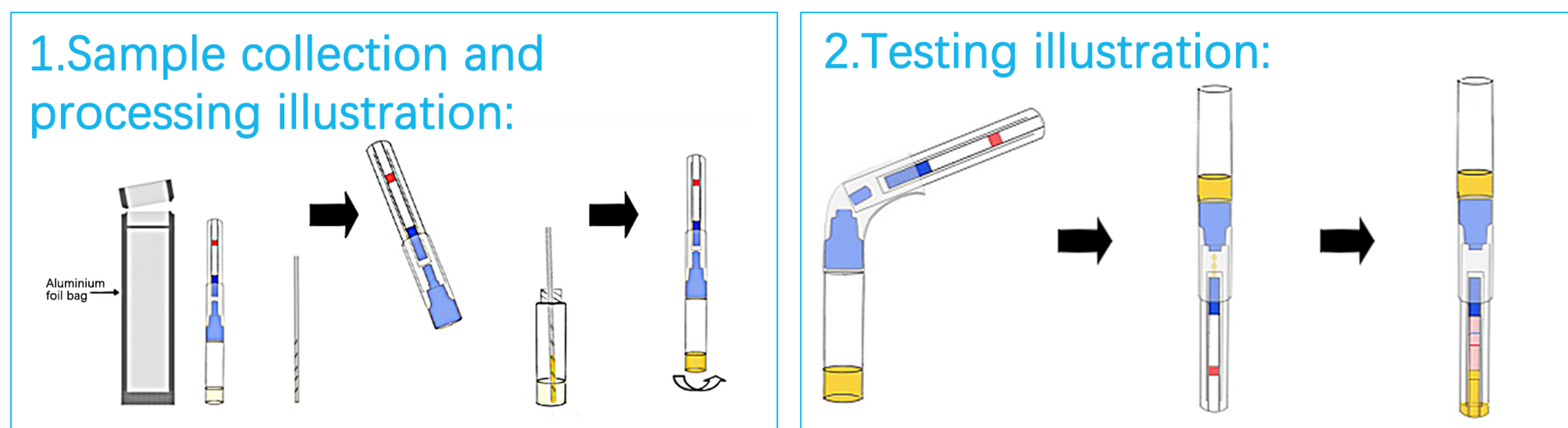

## 【Result Reading】

### Positive

Positive: Both the quality control line (C line)

### Negative

Only the quality control line

### Invalid

Quality control line does not appear. Shall take a new test card to retest.



## 【Result Reading】

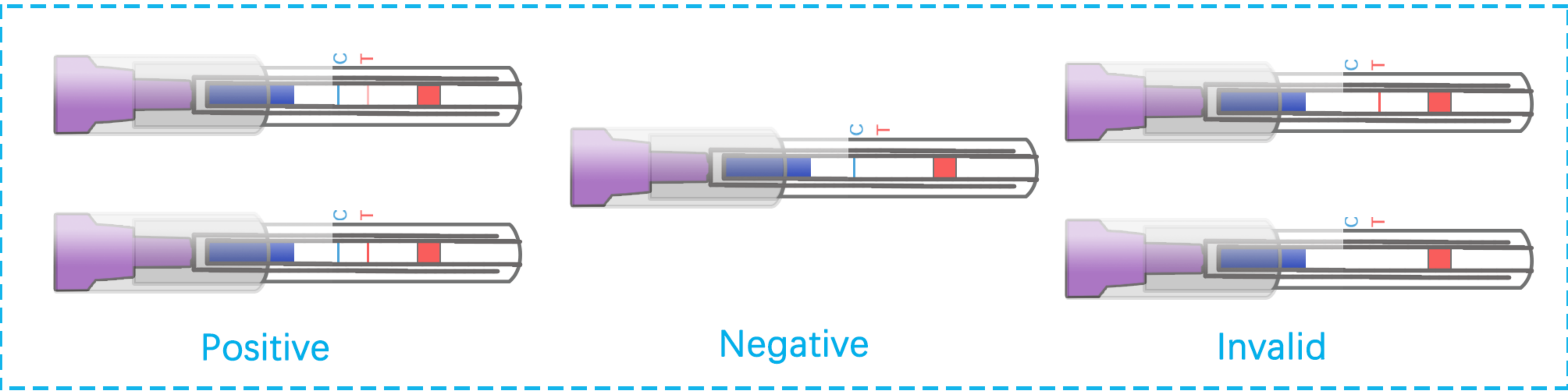

## Product Catalog

项目	型号	项目	型号
Canine Distemper Virus Antigen (CDV Ag) Test Kit	CDV Ag	Canine Relaxin (RLN) Test Kit	RLN
Canine Distemper Virus Antibody (CDV Ab) Test Kit	CDV Ab	C-reactive Protein (CRP) Test Kit	CRP
Canine Parvovirus Antigen (CPV Ag) Test Kit	CPV Ag	Feline Coronavirus Antigen (FCoV Ag) Test Kit	FCoV Ag
Canine Parvovirus Antibody (CPV Ab) Test Kit	CPV Ab	Feline Coronavirus Antibody (FCoV Ab) Test Kit	FCoV Ab
Canine Coronavirus Antigen (CCV Ag) Test Kit	CCV Ag	Feline Panleukopenia Virus Antigen (FPV Ag) Test Kit	FPV Ag
Canine Influenza Virus Antigen (CIV Ag) Test Kit	CIV Ag	Feline Panleukopenia Virus Antibody (FPV Ab) Test Kit	FPV Ab
Canine Adenovirus Antigen (CAV Ag) Test Kit	CAV Ag	Feline Leukemia Antigen (FELV Ag) Test Kit	FELV Ag
Rabies Antigen (RBV Ag) Test Kit	RBV Ag	Feline Immunodeficiency Virus Antibody (FIV Ab) Test Kit	FIV Ab
Rabies Antibody (RBV Ab) Test Kit	RBV Ab	Feline/Canine Heartworm Antigen (FCHW Ag) Test Kit	FCHW Ag
Canine Rotavirus Antigen (CRV Ag) Test Kit	CRV Ag	Toxoplasma Gondii Antigen (TOXO Ag) Test Kit	TOXO Ag
Canine Pancreatic Lipase (CPL) Test Kit	CPL	Toxoplasma Gondii Antibody (TOXO Ab) Test Kit	TOXO Ab
Canine Leishmania Antibody (LSH Ab) Test Kit	LSH Ab	Giardia Antigen (GIA Ag) Test Kit	GIA Ab
Brucella Canis Antibody (B. canis Ab) Test Kit	B.Canis Ab	Canine Relaxin Antigen (RLN Ag) Test Kit	RLN Ag

## 【Special Announcement】

This screening product is for domestic use , does not fall within the range of the definition of veterinary medicine,does not belong to veterinary medicine.

